

WAKE

COUNTY

N.S.R.R. owns half interest in pass track
13+15 = P.S.

N.S.R.R. owns in entirety all tracks
shown in solid lines
(on both S.A.L. & N.S. Rights-of-Way)

BONSAL

SEE CONTRACT AGREEMENT
FOR JOINT FACILITIES WITH
S.A.L.R.Y. Box 4: ENV. 7.

S.A.L. maintains and N.S.R.R. pays one half

of cost of maintaining:
All of pass track
All of house track
Turnout of connection track

See agreement of June 14, 1929,
and supplemented Feb. 2, 1938

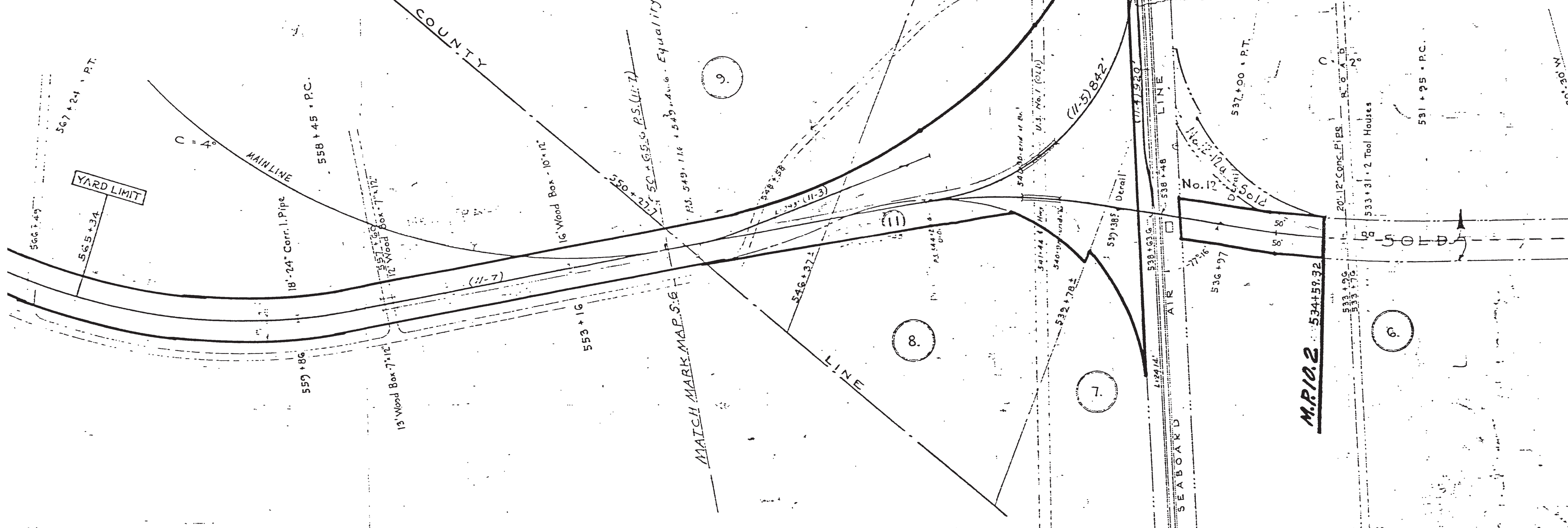

9

8

7

6

YARD LIMIT

MAIN LINE

COUNTY

MATCH MARK MAP 5.6

LINE

SEABOARD AIR LINE

M.P. 10.2 534+59.32

SOLD

30° 30' E