

- 0
- * 1 Wiring
- * 2 Title Block
- * 3 Photos
- * 4 Sketches
- * 5 Completed
- * 6 Wire Types
- * 7 Wires of Platform 3 NOT installed
- * 8 New wires for Platform 3
- * 9 Right of Way
- * 10
- * 11 Platforms

Direct Burial Cable
12/3 UFB
This cable is run in an unsealed cracked conduit

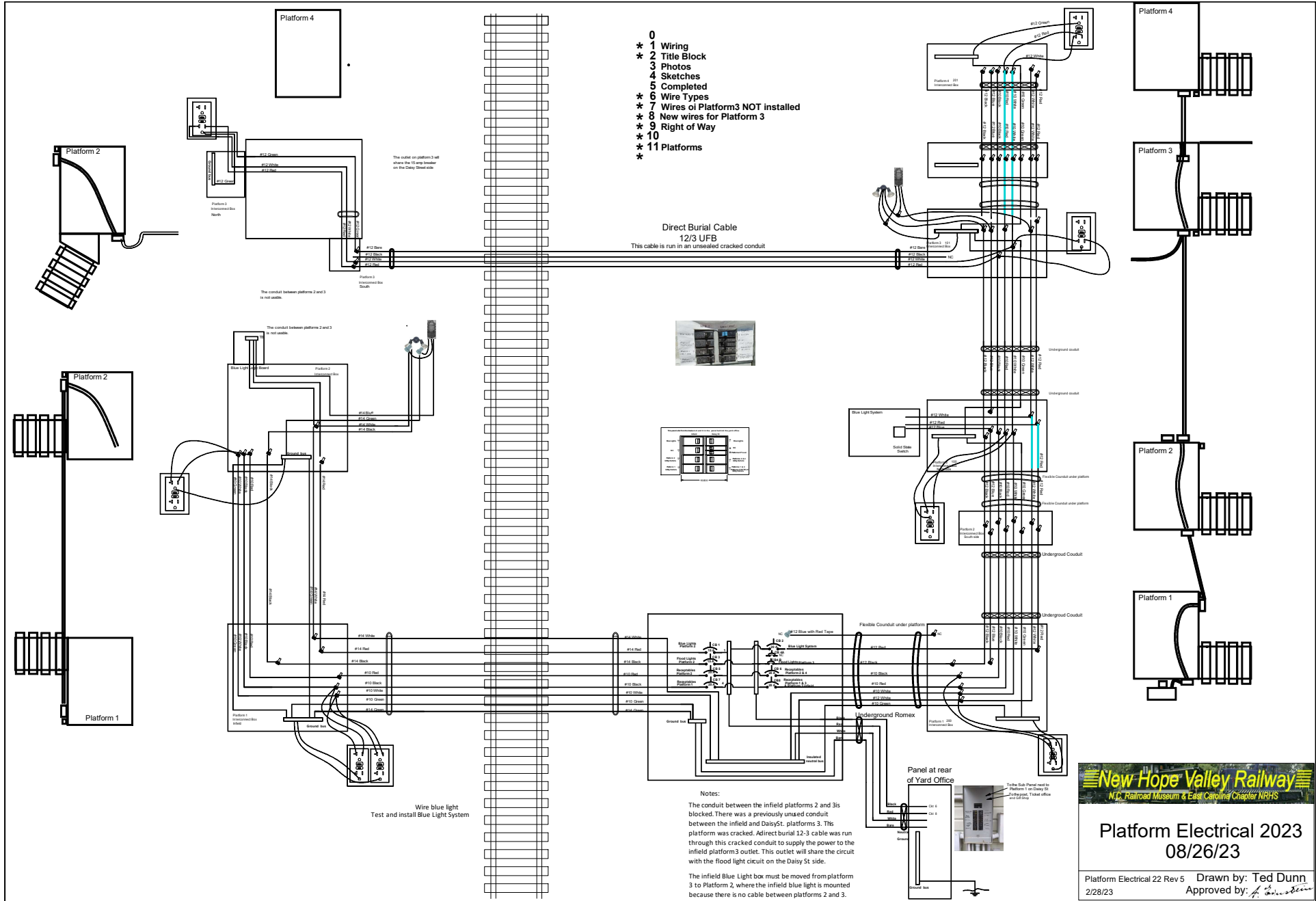

Wire blue light
Test and install Blue Light System

Notes:

The conduit between the infield platforms 2 and 3 is blocked. There was a previously unused conduit between the infield and Daisy St. platforms 3. This platform was cracked. Adirect burial 12-3 cable was run through this cracked conduit to supply the power to the infield platform 3 outlet. This outlet will share the circuit with the flood light circuit on the Daisy St side.

The infield Blue Light box must be moved from platform 3 to Platform 2, where the infield blue light is mounted because there is no cable between platforms 2 and 3.



Platform Electrical 2023
08/26/23

Platform Electrical 22 Rev 5 Drawn by: Ted Dunn
2/28/23 Approved by: *[Signature]*